

REPLACEMENT SEAL-33'-GEN 3

THESE PARTS AND THE FASTENERS ARE INCLUDED IN THE PARTS BOX

OPTIONAL ACCESSORIES SHADES AND SCREENS SEE DRAWING P-25043

(POST ASS'Y NO. 1)

FASTENERS ARE INCLUDED IN THE PARTS BOX

No	QTY	DESCRIPTION	PART No.	ASSEMBLY DRAWING
1	1	COVER MOCHA-REPLACEMENT AMERICA-03	202820	N/A
		COVER MOCHA-REPLACEMENT AMERICA-WITH LIGHTS-03	202860	
		COVER SLATE-REPLACEMENT AMERICA-03	202819	
		COVER SLATE-REPLACEMENT AMERICA-WITH LIGHTS-03	202861	
* 2	1	MOTOR SIDE FRAME ASS'Y-MOCHA	201327	OASIS-SP5
		MOTOR SIDE FRAME ASS'Y-SLATE	201365	
		MOTOR SIDE FRAME ASS'Y-EUR-MOCHA	204113	
		MOTOR SIDE FRAME ASS'Y-EUR-SLATE	204115	
3	1	POST ASS'Y NO. 3-MOCHA	201329	OASIS-SP11
		POST ASS'Y NO. 3-SLATE	201368	
4	1	POST ASS'Y NO. 4-MOCHA	201330	OASIS-SP12
		POST ASS'Y NO. 4-SLATE	201369	
* 5	2	FRAME-86-38-2.5-2470-W/HOLES-MOCHA-1	200242	N/A
		FRAME-86-38-2.5-2470-W/HOLES-SLATE-1	200241	
6	2	FRAME-86-38-2.5-490-W/HOLES-MOCHA-1	200248	N/A
		FRAME-86-38-2.5-490-W/HOLES-SLATE-1	200249	
* 7	1	ENTRANCE-SIDE FRAME ASS'Y-MOCHA	201333	OASIS-SP7
		ENTRANCE-SIDE FRAME ASS'Y-SLATE	201371	
* 8	2	TUBE-19-19-1.6-2423-DRIVE SHAFT WITH ORINGS	203877	N/A
9	1	COVANA SEAL-33'-GEN 3-KIT	212596	N/A
10	1	PARTS BOX FOR COVANA-MOCHA	201146	OASIS-SP4
		PARTS BOX FOR COVANA-SLATE	201147	
11	4	WINTER SEAL-MOCHA (COVANA C2)	200265	N/A
		WINTER SEAL-SLATE (COVANA C2)	200266	N/A
		COV-OAS-ALL WEATHER SEAL (COVANA C3)	204046	N/A

\* ONLY FOR STANDARD CONFIGURATION WHEN THE OPERATOR IS INSTALLED ON THE SHORT SIDE. FOR LONG SIDE (LS) OPTIONAL CONFIGURATION, SEE DRAWING OASIS-SP2

DESCRIPTION	PART No.
COVANA MOCHA-03	202587
COVANA MOCHA-03 WITH LIGHTS	201167
COVANA SLATE-03	202713
COVANA SLATE-03 WITH LIGHTS	201168
COVANA MOCHA-EUR-03	204091
COVANA MOCHA-EUR-03 WITH LIGHTS	204090
COVANA SLATE-EUR-03	204092
COVANA SLATE-EUR-03 WITH LIGHTS	204093

 <small>DRUMMONDVILLE, QUEBEC, CANADA          TEL: (819) 477-1335, (877) 278-8010          FAX: (819) 477-7212</small>	<b>TITLE</b> COVANA GEN 3 SPARE PARTS	
	<small>ARTICLE CODE:</small> SEE TABLE	<small>MATERIAL:</small> -
<small>DRAWN BY:</small> J.A.	<small>CHECK BY:</small> M.L.	<small>DATE:</small> 2013/04/16
<small>NO.</small>	<small>DATE</small>	<small>REVISION</small>
<small>BY</small>	<small>SCALE</small> N.T.S.	<small>DWG. #</small> OASIS-SP1
<small>REV.</small>	<small>PAGE</small> 1/1	

NO.	DATE	REVISION	BY
			J.A.

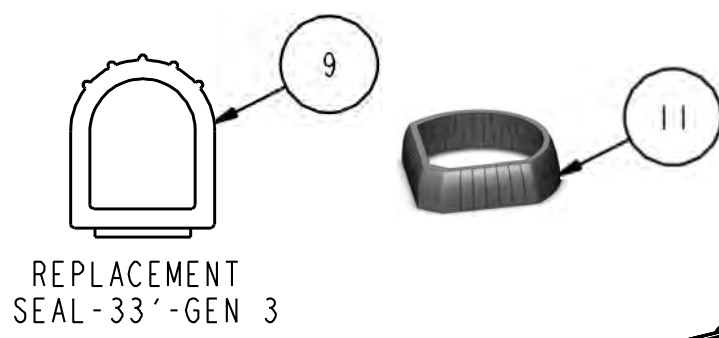

REPLACEMENT SEAL-33'-GEN 3

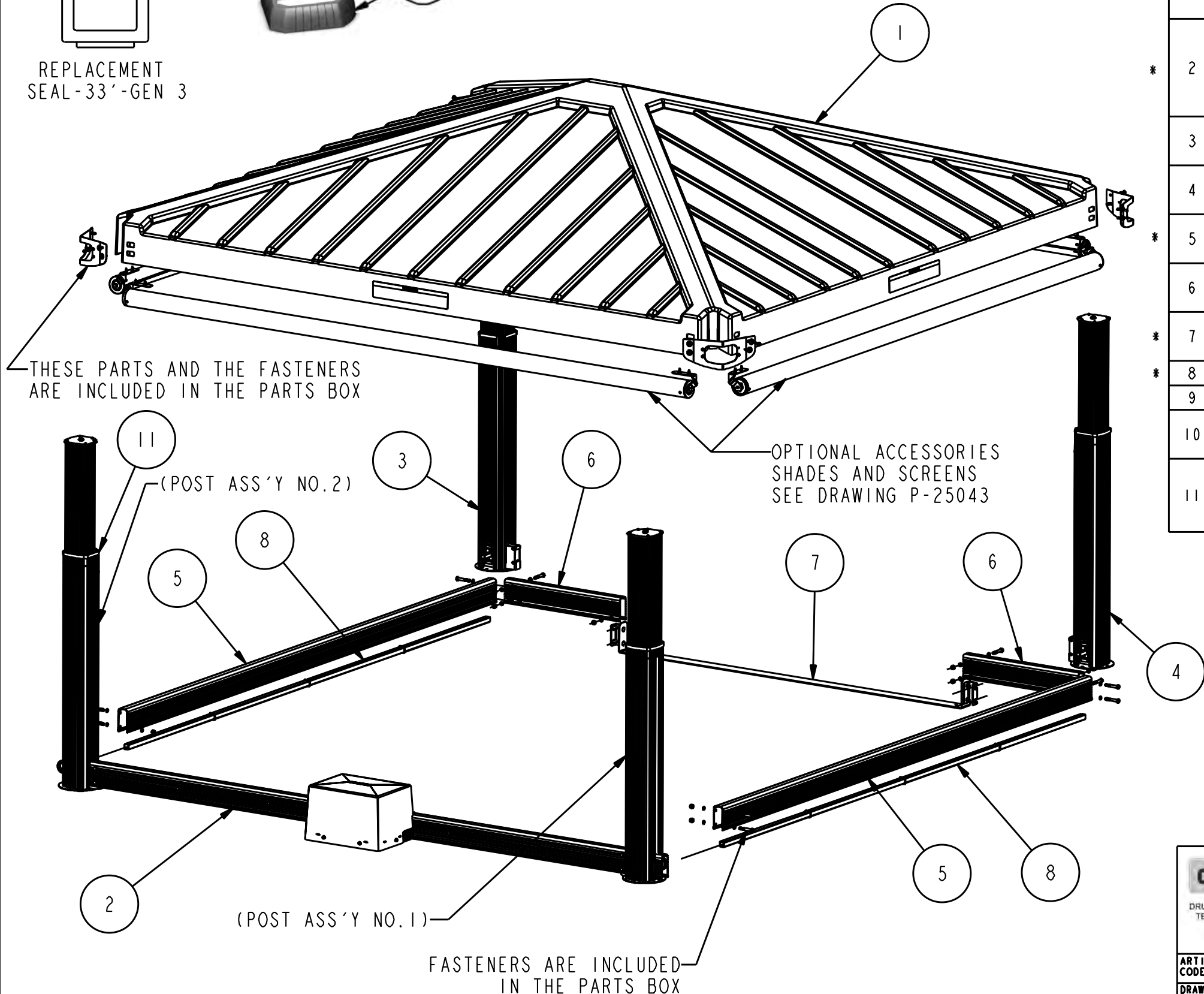

THESE PARTS AND THE FASTENERS ARE INCLUDED IN THE PARTS BOX

OPTIONAL ACCESSORIES SHADES AND SCREENS SEE DRAWING P-25043

(POST ASS'Y NO. 1)

(POST ASS'Y NO. 2)

FASTENERS ARE INCLUDED IN THE PARTS BOX

No	QTY	DESCRIPTION	PART No.	ASSEMBLY DRAWING
1	1	COVER MOCHA-REPLACEMENT AMERICA-03	202820	N/A
		COVER MOCHA-REPLACEMENT AMERICA-WITH LIGHTS-03	202860	
		COVER SLATE-REPLACEMENT AMERICA-03	202819	
		COVER SLATE-REPLACEMENT AMERICA-WITH LIGHTS-03	202861	
2	1	MOTOR SIDE FRAME ASS'Y-MOCHA-LS	202866	OASIS-SP6
		MOTOR SIDE FRAME ASS'Y-SLATE-LS	202865	
		MOTOR SIDE FRAME ASS'Y-EUR-MOCHA-LS	204114	
		MOTOR SIDE FRAME ASS'Y-EUR-SLATE-LS	204116	
3	1	POST ASS'Y NO.3-MOCHA	201329	OASIS-SP11
		POST ASS'Y NO.3-SLATE	201368	
4	1	POST ASS'Y NO.4-MOCHA	201330	OASIS-SP12
		POST ASS'Y NO.4-SLATE	201369	
5	2	FRAME-86-38-2.5-2337-W/HOLES-MOCHA-1-LS	202800	N/A
		FRAME-86-38-2.5-2337-W/HOLES-SLATE-1-LS	202799	
6	2	FRAME-86-38-2.5-490-W/HOLES-MOCHA-1	200248	N/A
		FRAME-86-38-2.5-490-W/HOLES-SLATE-1	200249	
7	1	ENTRANCE-SIDE FRAME ASS'Y-MOCHA-LS	202867	OASIS-SP8
		ENTRANCE-SIDE FRAME ASS'Y-SLATE-LS	202868	
8	2	TUBE-19-19-1.6-2289-DRIVE SHAFT WITH O-RINGS	203888	N/A
9	1	COVANA SEAL-33'-GEN 3-KIT	212596	N/A
10	1	PARTS BOX FOR COVANA-MOCHA	201146	OASIS-SP4
		PARTS BOX FOR COVANA-SLATE	201147	
11	4	WINTER SEAL-MOCHA (COVANA C2)	200265	N/A
		WINTER SEAL-SLATE (COVANA C2)	200266	N/A
		ALL WEATHER SEAL (COVANA C3)	204046	N/A

\* ONLY FOR OPTIONAL CONFIGURATION WHEN THE OPERATOR IS INSTALLED ON THE LONG SIDE (LS) FOR STANDARD CONFIGURATION, SEE DRAWING OASIS-SP1

DESCRIPTION	PART No.
COVANA MOCHA-03-LS	202715
COVANA MOCHA-03-LS-WITH LIGHTS	202716
COVANA SLATE-03-LS	202714
COVANA SLATE-03-LS-WITH LIGHTS	202717
COVANA MOCHA-EUR-03-LS	-
COVANA MOCHA-EUR-03 WITH LIGHTS-LS	-
COVANA SLATE-EUR-03-LS	-
COVANA SLATE-EUR-03 WITH LIGHTS-LS	-

		<b>TITLE</b> COVANA GEN 3-LS SPARE PARTS	
DRUMMONDVILLE, QUEBEC, CANADA TEL: (819) 477-1335, (877) 278-8010 FAX: (819) 477-7212		<b>MATERIAL:</b> -	<b>FINISH:</b> -
<b>ARTICLE CODE:</b> SEE TABLE	<b>SCALE</b> N.T.S.	<b>DWG. #</b> OASIS-SP2	<b>REV.</b> 1/1
<b>DRAWN BY:</b> J.A.	<b>CHECK BY:</b>	<b>APP. BY:</b> M.L.	<b>DATE:</b> 2013/04/26

NO.	DATE	REVISION	BY

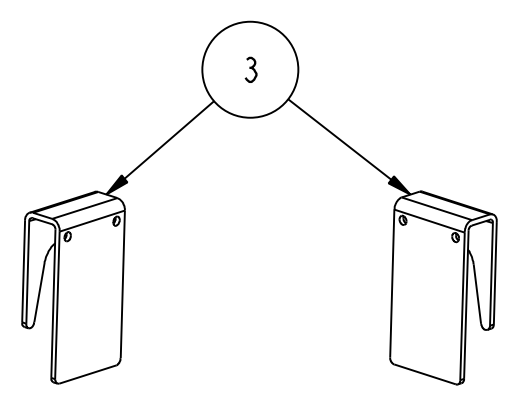
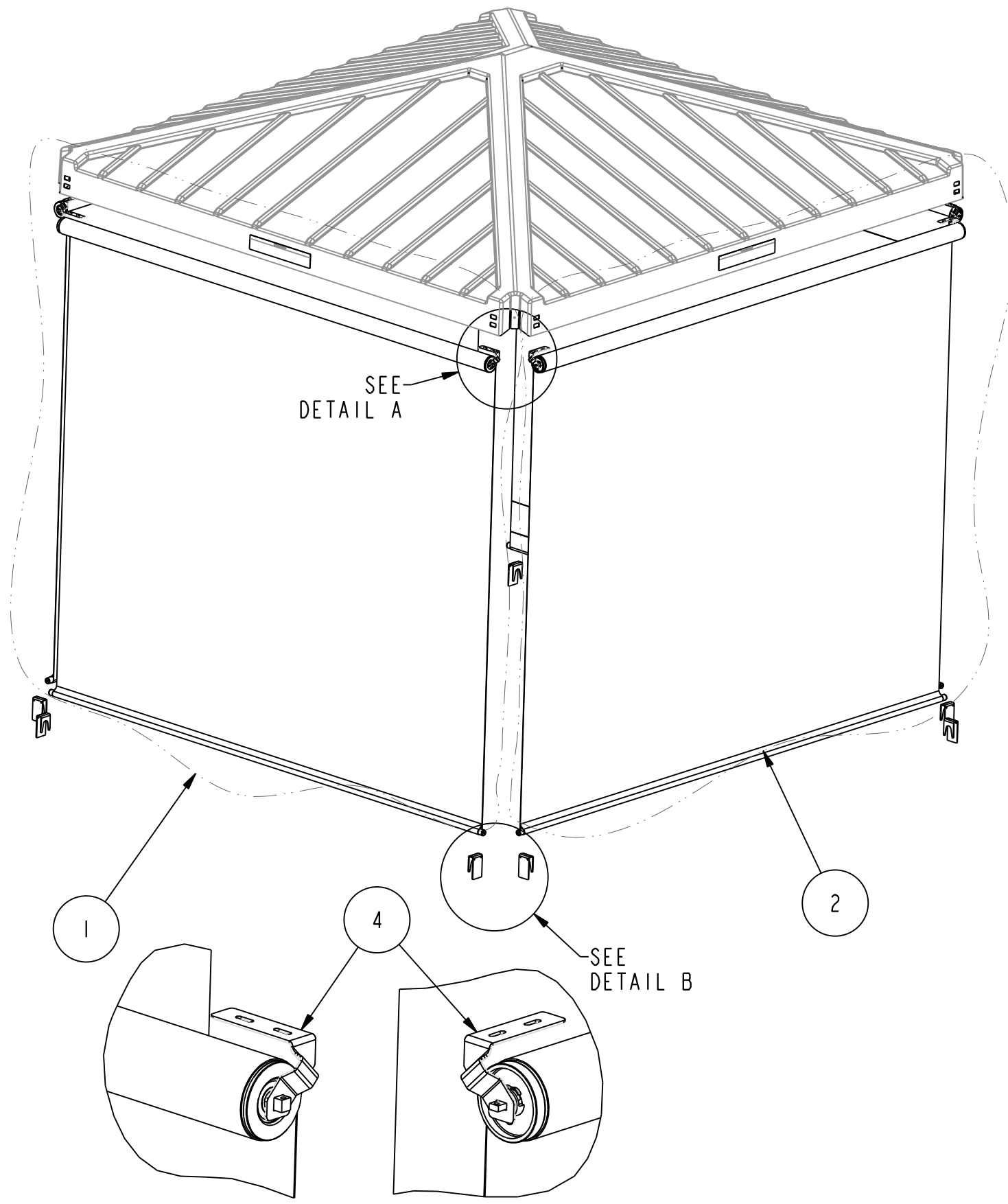

No	DESCRIPTION	PART No.
1	ROLLER SHADE FABRIC 88.25"-75"-MOCHA(KIT)	189541
	ROLLER SHADE FABRIC 88.25"-75"-SLATE(KIT)	189543
	ROLLER SHADE FULL SCREEN 88.25"-79"-MOCHA(KIT)	214297
	ROLLER SHADE FULL SCREEN 88.25"-79"-SLATE(KIT)	214296
	ROLLER SHADE SCREEN 88.25"-ZEN(KIT)-MOCHA	211186
	ROLLER SHADE SCREEN 88.25"-ZEN(KIT)-SLATE	211187
	ROLLER SHADE FABRIC 88.25"-ISLAND-MOCHA(KIT)	211190
	ROLLER SHADE FABRIC 88.25"-ISLAND-SLATE(KIT)	211191
2	ROLLER SHADE FABRIC 93.5"-75"-MOCHA(KIT)	189540
	ROLLER SHADE FABRIC 93.5"-75"-SLATE(KIT)	189542
	ROLLER SHADE FULL SCREEN 93.5"-79"-MOCHA(KIT)	214253
	ROLLER SHADE FULL SCREEN 93.5"-79"-SLATE(KIT)	214298
	ROLLER SHADE SCREEN 93.5"-ZEN(KIT)-MOCHA	211188
	ROLLER SHADE SCREEN 93.5"-ZEN(KIT)-SLATE	211189
	ROLLER SHADE FABRIC 93.5"-ISLAND-MOCHA(KIT)	211192
ROLLER SHADE FABRIC 93.5"-ISLAND-SLATE(KIT)	211193	
3	SCREEN RESTRAINT BRACKET+TAPE-(KIT)-MOCHA	201181
	SCREEN RESTRAINT BRACKET+TAPE-(KIT)-SLATE	201182
4	SCREEN BRACKET 45D-REPLACEMENT KIT	189987

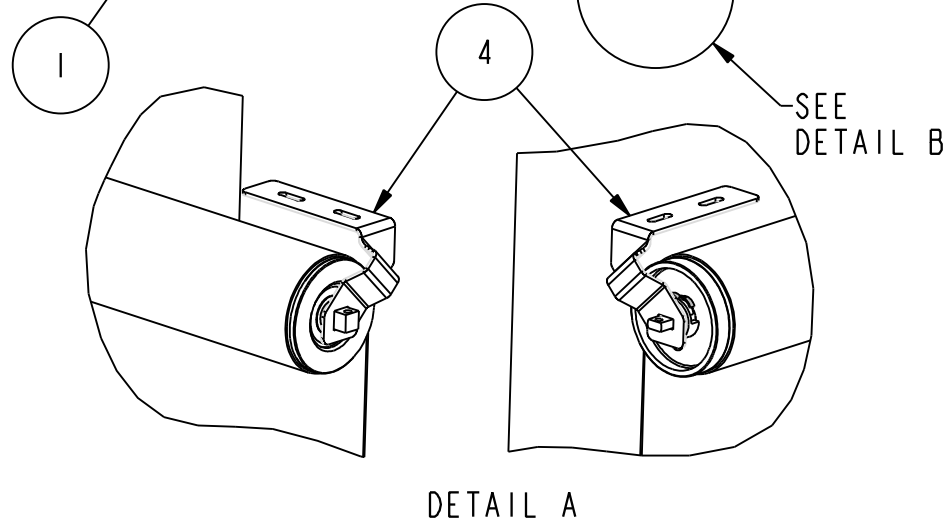

DETAIL B

		TITLE	
		COVANA SCREEN AND SHADE GEN 3	
DRUMMONDVILLE, QUEBEC, CANADA TEL: (819) 477-1335, (877) 278-8010 FAX: (819) 477-7212		MATERIAL:	FINISH:
ARTICLE CODE: SEE TABLE		-	-
DRAWN BY: <b>JA.</b> CHECK BY: APP. BY: <b>ML.</b>	DATE: 2013/04/29	SCALE: <b>N.T.S.</b> OASIS-SP3	REV. PAGE 1/1

NO.	DATE	REVISION	BY

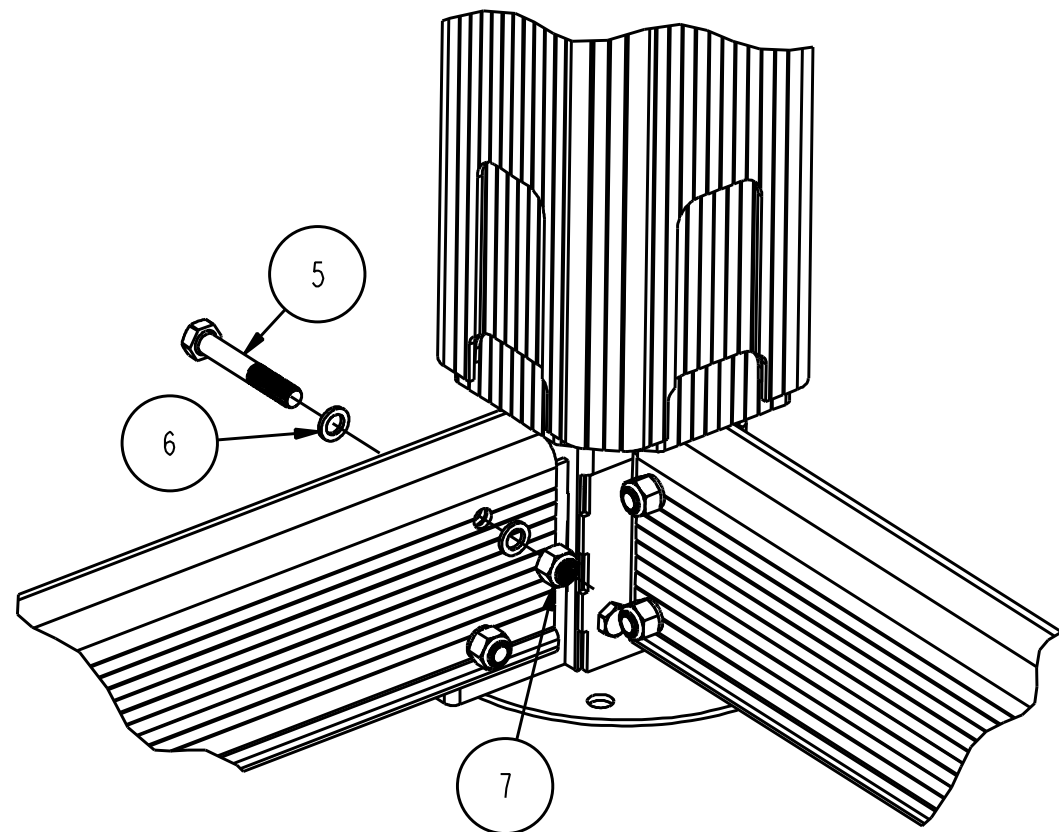
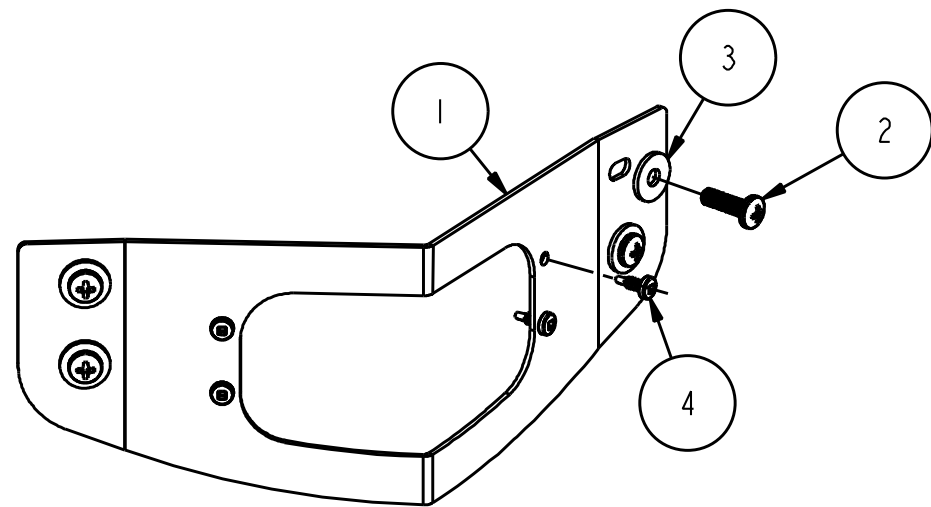

FRAME IS SHOWN  
FOR REFERENCE ONLY

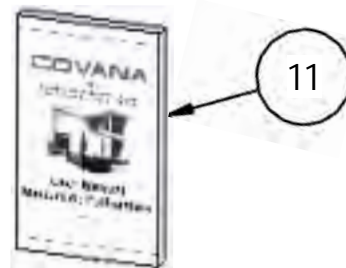

**AVERTISSEMENT**  
 RISQUE D'ENFERMEMENT ET DE NOYADE. AFIN D'ÉVITER TOUT RISQUE DE BLESSURE  
 OU DE NOYADE, SUIVRE TOUTES LES INSTRUCTIONS SPÉCIFIÉES DANS LE MANUEL  
 DU MANUFACTURIER. INSPECTER RÉGULIÈREMENT LE COUVERCLE.  
 LE COUVERCLE RÉPOND AUX NORMES ASTM F1346-91 (2010).  
 POUR DE PLUS AMPLES INFORMATIONS, CONTACTER: www.covana.com

No	QTY	DESCRIPTION	PART No.
1	4	CLAMP OUTSIDE BRACKET-MOCHA	196473
		CLAMP OUTSIDE BRACKET-SLATE	200039
2	16 (+1)	M6-1.0 x 20mm PHILIPS PAN HEAD MACHINE SCREW-Z/P-MOCHA	202006
		M6-1.0 x 20mm PHILIPS PAN HEAD MACHINE SCREW-Z/P-SLATE	202005
3	16 (+1)	1/4" SAE FLAT WASHER-Z/P-MOCHA	201999
		1/4" SAE FLAT WASHER-Z/P-SLATE	201998
4	16 (+1)	#8 x 1/2" SQUARE #2 PAN HEAD SELF DRILLING SCREW-Z/P-MOCHA	202010
		#8 x 1/2" SQUARE #2 PAN HEAD SELF DRILLING SCREW-Z/P-SLATE	202009
5	16 (+1)	5/16"-18 x 2" HEX CAP SCREW-Z/P-MOCHA	202001
		5/16"-18 x 2" HEX CAP SCREW-Z/P-SLATE	202000
6	32 (+1)	5/16"ID x 1/2"OD x 1/16"THK NYLON FLAT WASHER	198684
7	16 (+1)	5/16"-18 HEX NYLON LOCK NUT-Z/P-MOCHA	202003
		5/16"-18 HEX NYLON LOCK NUT-Z/P-SLATE	202002
8	1	#2 X 2" ROBERTSON (SQUARE) DRIVE BIT	188924
9	8	STICKER COVANA SAFETY (FRENCH)	189199
10	1	COVANA USER-MANUAL-GEN 3	202557
11	1	COVANA INSTALLATION-SERVICE-MANUAL-GEN 3	202558
12	1	MARKER MOCHA	201234
		MARKER SLATE	201235

DESCRIPTION	PART No.
PART'S BOX FOR COVANA-MOCHA	201146
PART'S BOX FOR COVANA-SLATE	201147

<b>COVANA</b> DRUMMONDVILLE, QUEBEC, CANADA TEL: (819) 477-1335, (877) 278-8010 FAX: (819) 477-7212		TITLE <b>COVANA GEN 3 PART'S BOX</b>			
ARTICLE CODE: SEE TABLE	TOLERANCES (IF NOT SPECIFIED)	MATERIAL:	FINISH:		
DRAWN BY: J.A.	CHECK BY:	APP. BY: M.L.	DATE: 2013/04/26	SCALE: N.T.S.	DWG. # OASIS-SP4
NO.	DATE	REVISION	BY	REV.	PAGE 1/1

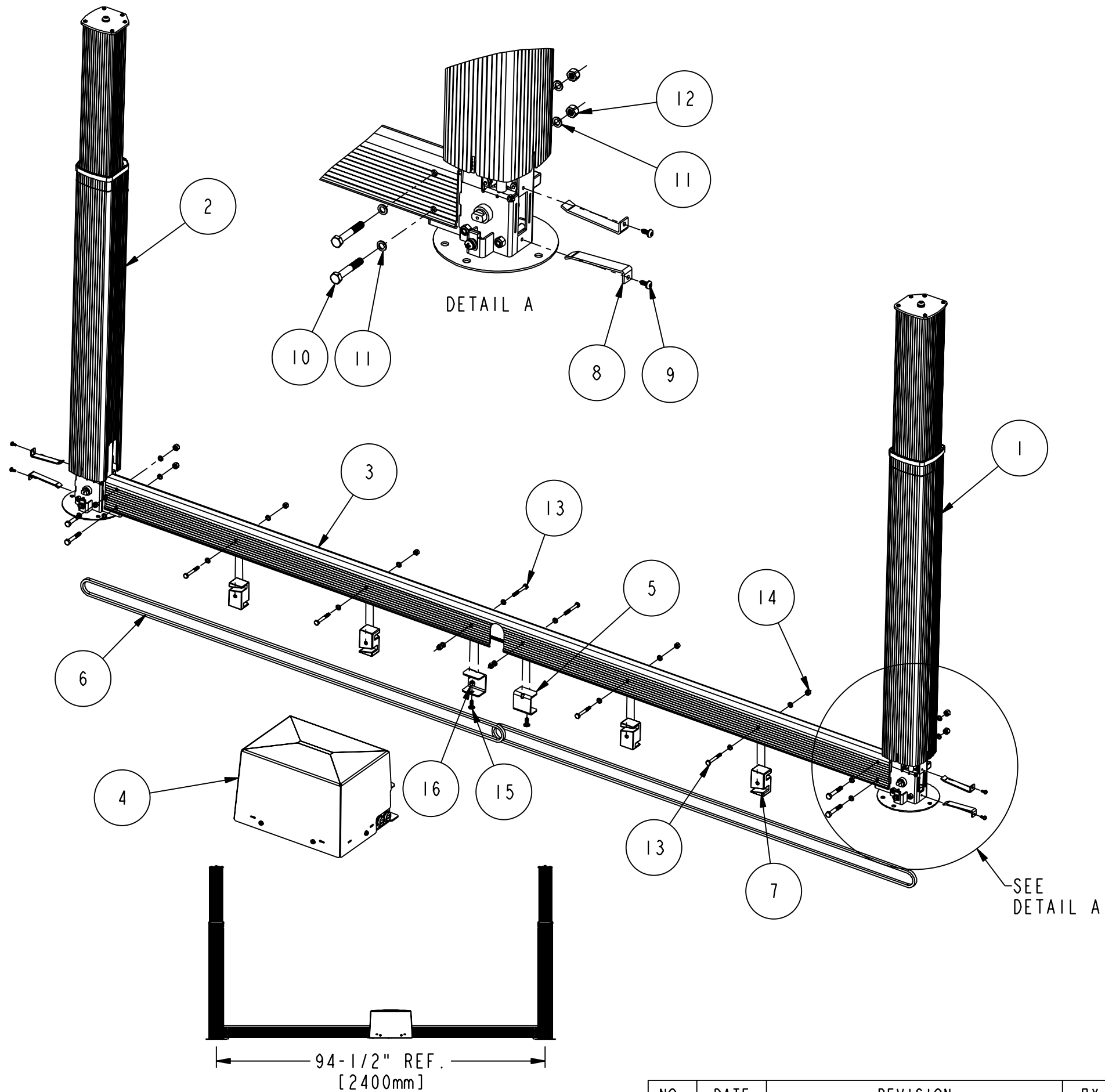

No	QTY	DESCRIPTION	PART No.
1	1	POST ASS'Y NO.1-MOCHA	201331
		POST ASS'Y NO.1-SLATE	201366
2	1	POST ASS'Y NO.2-MOCHA	201328
		POST ASS'Y NO.2-SLATE	201367
3	1	FRAME-86-38-2.5-2310-W/HOLES-MOCHA-1	200244
		FRAME-86-38-2.5-2310-W/HOLES-SLATE-1	200245
4	1	OPERATOR COVANA-UL(1/2HP-115V/IPH-60HZ-40:1)	189275
		OPERATOR COVANA-CE(1/2HP-220V/IPH-50HZ-40:1)	189274
5	2	U-PLATE 1:1/4-2-2-1/8THK	187349
6	2	410-1R198P(INCL.1 C/L)(CR)	189202
7	4	CHAIN BINDER	187348
8	4	PLATE 4X5/8X12GA(1 HOLE)	187235
9	4	#10-12 x 1/2" SQUARE PAN HEAD SHEET METAL SCREW Z/P	202108
10	4	5/16-18-2(HEX CAP SCREW-Z/P)-MOCHA	202001
		5/16-18-2(HEX CAP SCREW-Z/P)-SLATE	202000
11	20	5/16" ID x 1/2" OD x 1/16" THK NYLON FLAT WASHER	198684
12	4	5/16-18 HEX NYLON LOCK NUT-Z/P-MOCHA	202003
		5/16-18 HEX NYLON LOCK NUT-Z/P-SLATE	202002
13	6	1/4-20-2(HEX CAP SCREW-Z/P)-MOCHA	202016
		1/4-20-2(HEX CAP SCREW-Z/P)-SLATE	202015
14	6	1/4-20 HEX NYLON LOCK NUT-MOCHA	201997
		1/4-20 HEX NYLON LOCK NUT-SLATE	201996
15	2	1/4-20-3/4(CARR.BOLT)-Z/P	185997
16	2	1/4-20 HEX NYLON LOCK NUT	156435

FOR OPTIONAL CONFIGURATION WHEN THE OPERATOR IS INSTALLED ON THE LONG SIDE (LS), SEE DRAWING P-24606.

DESCRIPTION	PART No.
MOTOR SIDE FRAME ASS'Y-UL-MOCHA	201327
MOTOR SIDE FRAME ASS'Y-UL-SLATE	201365
MOTOR SIDE FRAME ASS'Y-CE-MOCHA	204113
MOTOR SIDE FRAME ASS'Y-CE-SLATE	204115

		TITLE	
DRUMMONDVILLE, QUEBEC, CANADA TEL: (819) 477-1335, (877) 278-8010 FAX: (819) 477-7212		<b>MOTOR-SIDE FRAME ASS'Y GEN3</b>	
ARTICLE CODE:	SEE TABLE	TOLERANCES (IF NOT SPECIFIED)	
DRAWN BY:	CHECK BY:	APP. BY:	DATE:
JA.		ML.	2012/10/03
SCALE	DWG. #	REV.	PAGE
N.T.S.	OASIS-SP5		1/1

NO.	DATE	REVISION	BY

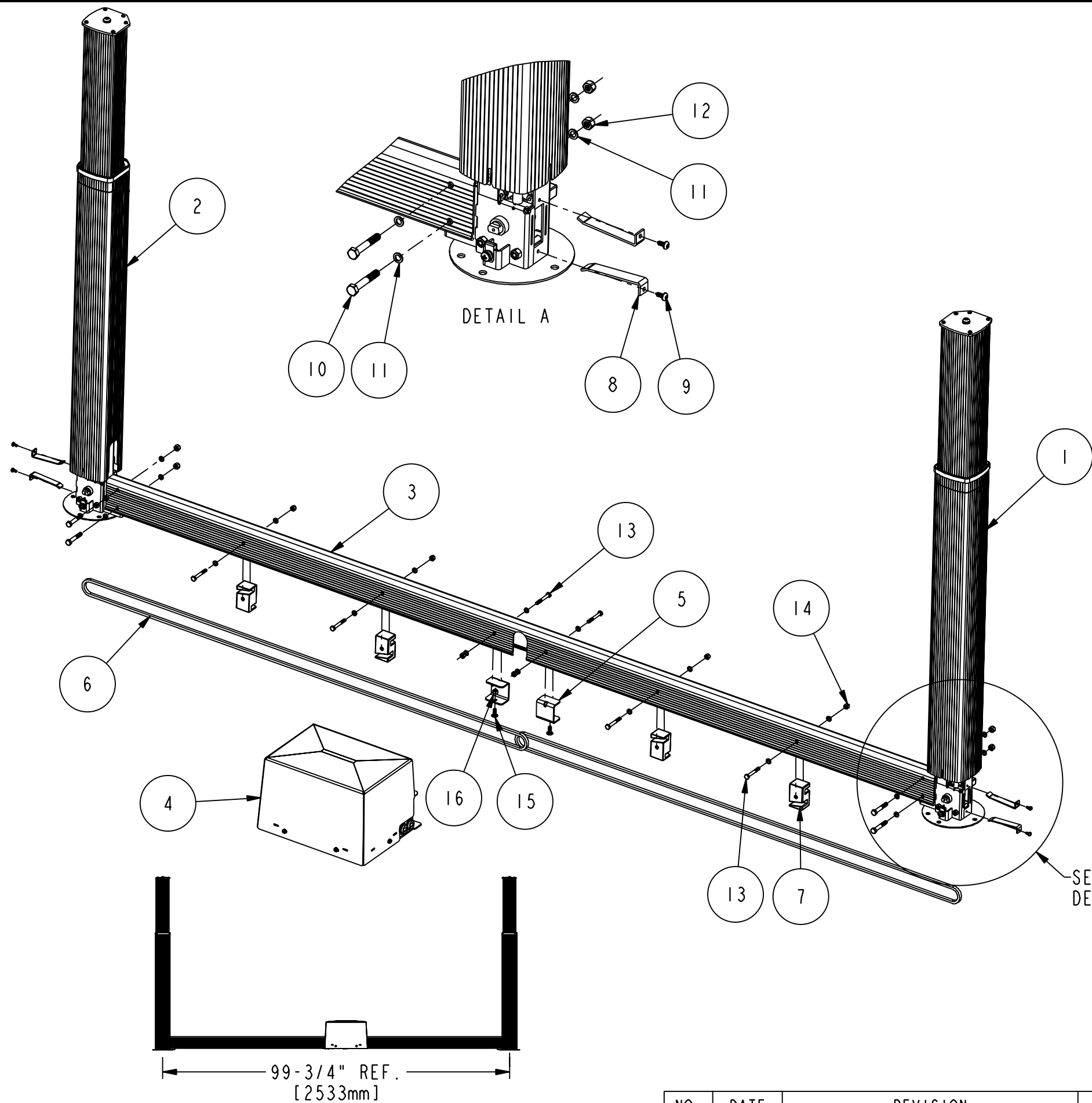

No	QTY	DESCRIPTION	PART No.
1	1	POST ASS'Y NO.1-MOCHA	201331
		POST ASS'Y NO.1-SLATE	201366
2	1	POST ASS'Y NO.2-MOCHA	201328
		POST ASS'Y NO.2-SLATE	201367
* 3	1	FRAME-86-38-2.5-2441-W/HOLES-MOCHA-I-LS	202801
		FRAME-86-38-2.5-2441-W/HOLES-SLATE-I-LS	202802
4	1	OPERATOR COVANA-UL(1/2HP-115V/IPH-60HZ-40:1)	189275
		OPERATOR COVANA-CE(1/2HP-220V/IPH-50HZ-40:1)	189274
5	2	U-PLATE 1:1/4-2-2-1/8THK	187349
* 6	2	410-1R208P (INCL.1 C/L)(CR)	194697
7	4	CHAIN BINDER	187348
8	4	PLATE 4X5/8X12GA(1 HOLE)	187235
9	4	#10-12 x 1/2" SQUARE PAN HEAD SHEET METAL SCREW Z/P	202108
10	4	5/16-18-2(HEX CAP SCREW-Z/P)-MOCHA	202001
		5/16-18-2(HEX CAP SCREW-Z/P)-SLATE	202000
11	20	5/16" ID x 1/2"ODx 1/16"THK NYLON FLAT WASHER	198684
12	4	5/16-18 HEX NYLON LOCK NUT-Z/P-MOCHA	202003
		5/16-18 HEX NYLON LOCK NUT-Z/P-SLATE	202002
13	6	1/4-20-2(HEX CAP SCREW-Z/P)-MOCHA	202016
		1/4-20-2(HEX CAP SCREW-Z/P)-SLATE	202015
14	6	1/4-20 HEX NYLON LOCK NUT-MOCHA	201997
		1/4-20 HEX NYLON LOCK NUT-SLATE	201996
15	2	1/4-20-3/4(CARR.BOLT)-Z/P	185997
16	2	1/4-20 HEX NYLON LOCK NUT	156435

\*SPECIFIC PARTS NEEDED FOR OPTIONAL CONFIGURATION WHEN THE OPERATOR IS INSTALLED ON THE LONG SIDE (LS)

DESCRIPTION	PART No.
MOTOR SIDE FRAME ASS'Y-UL-MOCHA-LS	202866
MOTOR SIDE FRAME ASS'Y-UL-SLATE-LS	202865
MOTOR SIDE FRAME ASS'Y-CE-MOCHA-LS	204114
MOTOR SIDE FRAME ASS'Y-CE-SLATE-LS	204116

		TITLE	
DRUMMONDVILLE, QUEBEC, CANADA TEL: (819) 477-1335, (877) 278-8010 FAX: (819) 477-7212		<b>MOTOR-SIDE FRAME ASS'Y-LS GEN3</b>	
ARTICLE CODE:	SEE TABLE	TOLERANCES (IF NOT SPECIFIED):	
DRAWN BY:	CHECK BY:	MATERIAL:	FINISH:
APP. BY:	DATE:	SCALE	DWG. #
JA.	2012/10/03	N.T.S.	OASIS-SP6
REVISION	BY	REV.	PAGE
			1/1

NO.	DATE	REVISION	BY

APROX. WEIGHT	
1.84 Lb	0.84 Kg

No	Qty	DESCRIPTION	PART No.
1	1	U-PLATE 4.1-52:7/8-2-1/8THK-MOCHA	200042
		U-PLATE 4.1-52:7/8-2-1/8THK-SLATE	196476
2	2	U-PLATE 1:1/4-1.6-3-1/8THK	187352
3	4	1/4"-20 x 3/4" ROUND HEAD CARRIAGE BOLT-Z/P-MOCHA	202014
		1/4"-20 x 3/4" ROUND HEAD CARRIAGE BOLT-Z/P-SLATE	202013
4	4	1/4"-20 HEX NYLON LOCK NUT-Z/P	156435

\* ONLY FOR STANDARD CONFIGURATION WHEN THE OPERATOR IS INSTALLED ON THE SHORT SIDE.  
FOR LONG SIDE (LS) OPTIONAL CONFIGURATION, SEE DRAWING P-24607

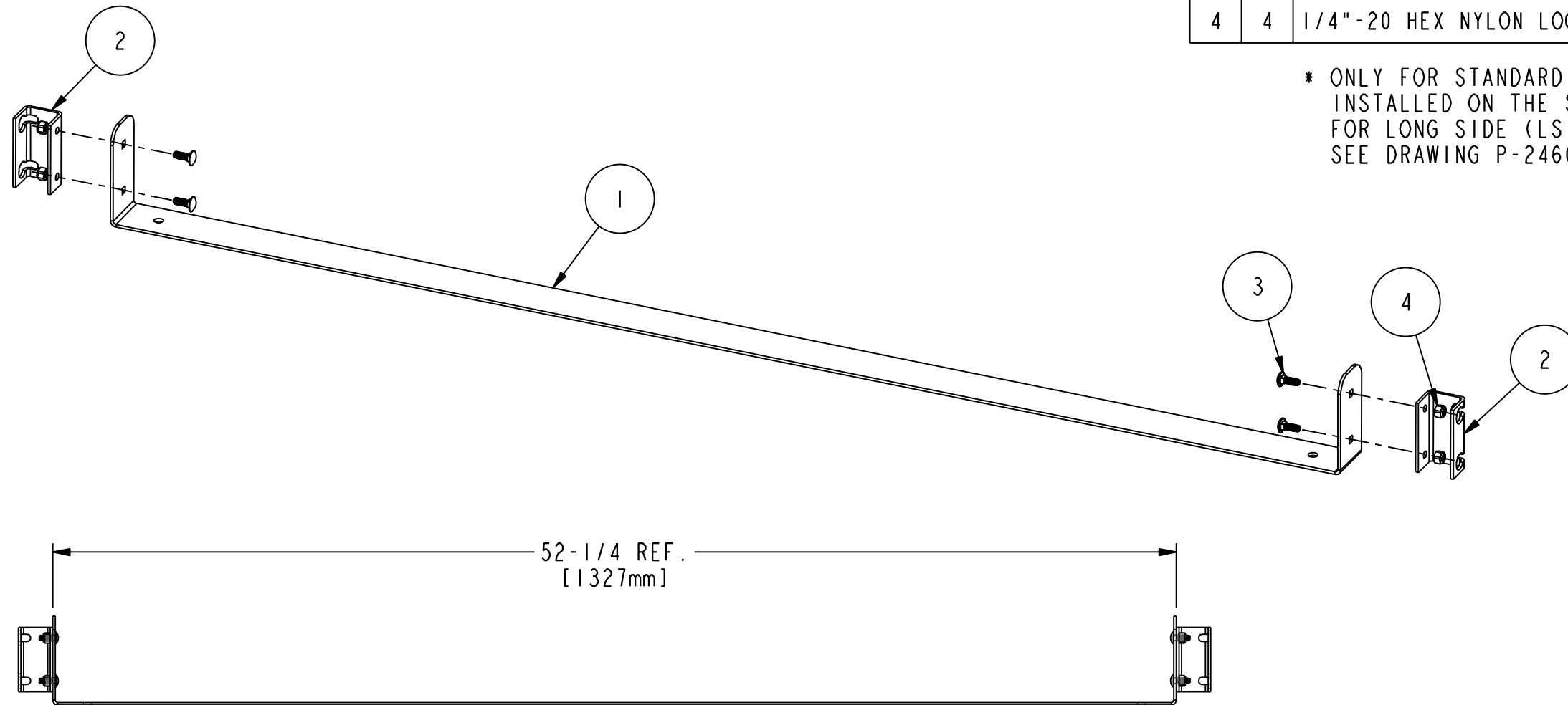

DESCRIPTION	PART No.
ENTRANCE-SIDE PLATE ASS'Y-MOCHA	201333
ENTRANCE-SIDE PLATE ASS'Y-SLATE	201371

 DRUMMONDVILLE, QUEBEC, CANADA TEL: (819) 477-1335, (877) 278-8010 FAX: (819) 477-7212	TITLE		
	ENTRANCE-SIDE PLATE ASS'Y GEN3		
ARTICLE CODE: SEE TABLE	TOLERANCES (IF NOT SPECIFIED)	MATERIAL:	FINISH:
DRAWN BY: <b>JA.</b> CHECK BY:    APP. BY: <b>ML.</b> DATE: 2012/10/05		SCALE: <b>N.T.S.</b>	DWG. #: <b>OASIS-SP7</b> REV.    PAGE <b>1/1</b>

NO.	DATE	REVISION	BY

APROX. WEIGHT	
1.97 Lb	0.89 Kg

No	Qty	DESCRIPTION	PART No.
1	1	U-PLATE 4.1-57:1/2-2-1/8THK-LS-MOCHA	202783
		U-PLATE 4.1-57:1/2-2-1/8THK-LS-SLATE	202782
2	2	U-PLATE 1:1/4-1.6-3-1/8THK	187352
3	4	1/4"-20 x 3/4" ROUND HEAD CARRIAGE BOLT-Z/P-MOCHA	202014
		1/4"-20 x 3/4" ROUND HEAD CARRIAGE BOLT-Z/P-SLATE	202013
4	4	1/4"-20 HEX NYLON LOCK NUT-Z/P	156435

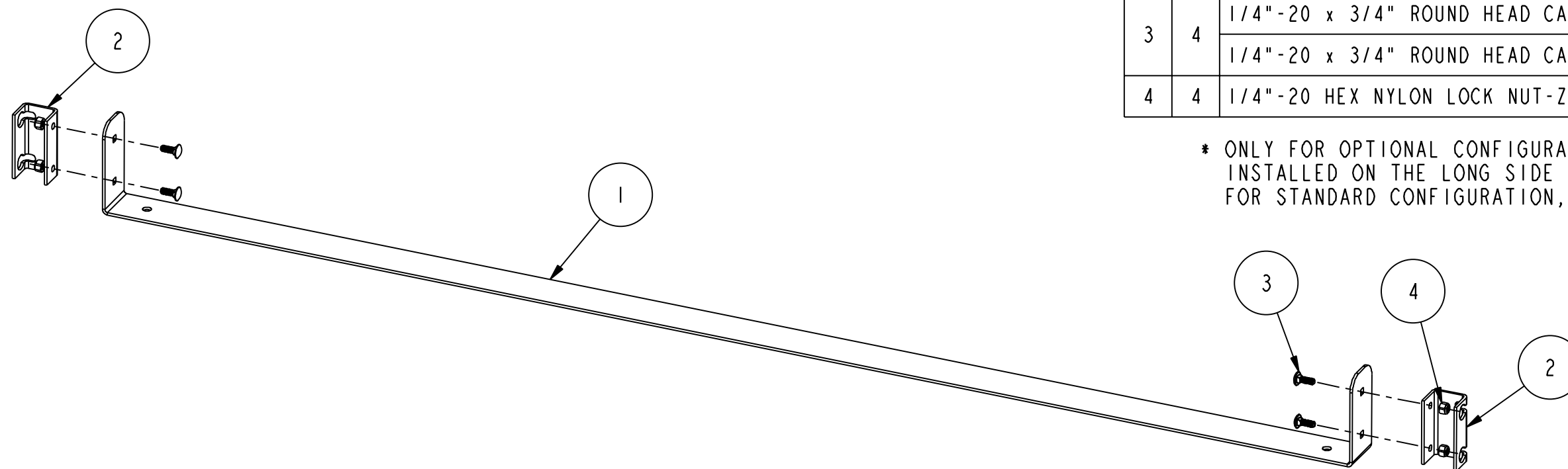

\* ONLY FOR OPTIONAL CONFIGURATION WHEN THE OPERATOR IS INSTALLED ON THE LONG SIDE (LS)  
FOR STANDARD CONFIGURATION, SEE DRAWING P-24599

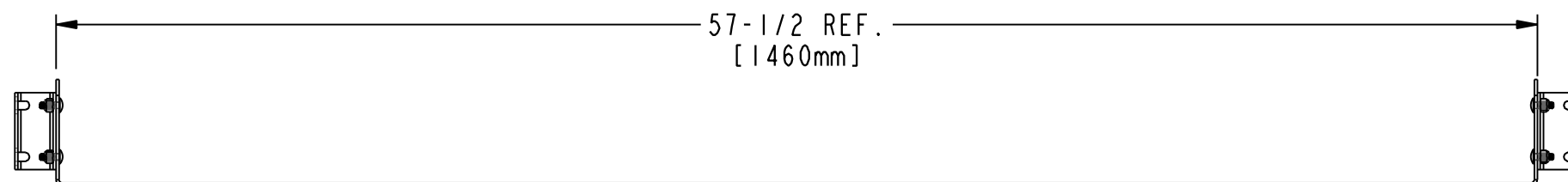

DESCRIPTION	PART No.
ENTRANCE-SIDE PLATE ASS'Y-MOCHA-LS	202867
ENTRANCE-SIDE PLATE ASS'Y-SLATE-LS	202868

 <small>DRUMMONDVILLE, QUEBEC, CANADA TEL: (819) 477-1335, (877) 278-8010 FAX: (819) 477-7212</small>	TITLE		
	ENTRANCE-SIDE PLATE ASS'Y LS GEN3		
ARTICLE CODE: SEE TABLE	TOLERANCES (IF NOT SPECIFIED)	MATERIAL:	FINISH:
<small>DRAWN BY: CHECK BY: APP. BY:</small> <b>JA.</b>	<small>DATE:</small> 2012/10/05	<small>SCALE</small> <b>N.T.S.</b>	<small>DWG. #</small> <b>OASIS-SP8</b>
<small>NO.</small> 	<small>DATE</small> 	<small>REVISION</small> 	<small>BY</small> <b>ML.</b>
<small>REV.</small> 		<small>PAGE</small> <b>1/1</b>	

NO.	DATE	REVISION	BY



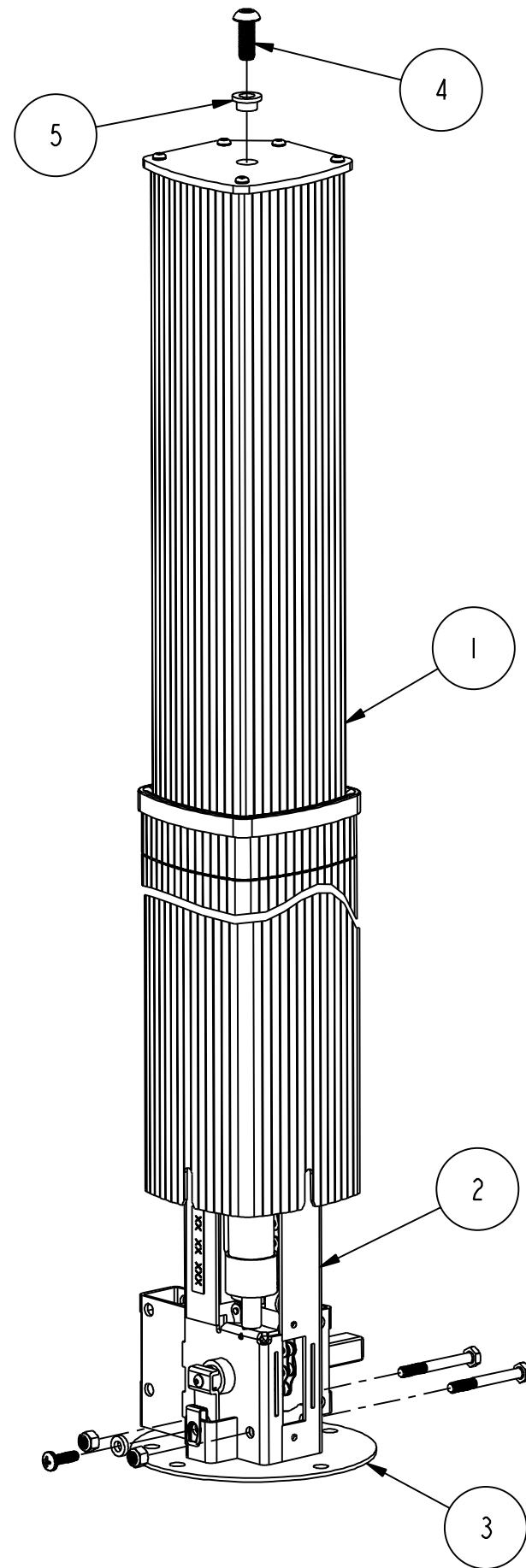



APROX. WEIGHT	
37 Lb	16.7 Kg

No	QTY	DESCRIPTION	ARTICLE CODE
1	1	SLEEVE ASSEMBLY WITH WINTER SEAL-MOCHA	201177
		SLEEVE ASSEMBLY WITH WINTER SEAL-SLATE	201176
2	1	VERTICAL POST-ASS'Y RIGHT(GEN2)	188970
3	1	VERTICAL POST-FOOT-MOCHA	200253
		VERTICAL POST-FOOT-SLATE	200254
4	1	3/8"-24 x 1" BUTTON HEAD SOCKET CAP SCREW-Z/P-MOCHA	202018
		3/8"-24 x 1" BUTTON HEAD SOCKET CAP SCREW-Z/P-SLATE	202017
5	1	BUSHING(9.6-12.5-8.5FL 18.0-2.5)AL-MOCHA	202872
		BUSHING(9.6-12.5-8.5FL 18.0-2.5)AL-SLATE	202873
6	2	1/4"-20 x 2-1/4" HEX CAP SCREW Z/P	188801
7	2	1/4"-20 HEX NYLON LOCK NUT-Z/P	156435
8	1	M6-1.0 x 20mm PHILIPS PAN HEAD MACHINE SCREW-MOCHA	202006
		M6-1.0 x 20mm PHILIPS PAN HEAD MACHINE SCREW-SLATE	202005
9	1	0.257"ID x 0.5"OD x 0.125" THICK NYLON FLAT WASHER	202158
10	1	M6-1.0 (PANEL NUT)	202159

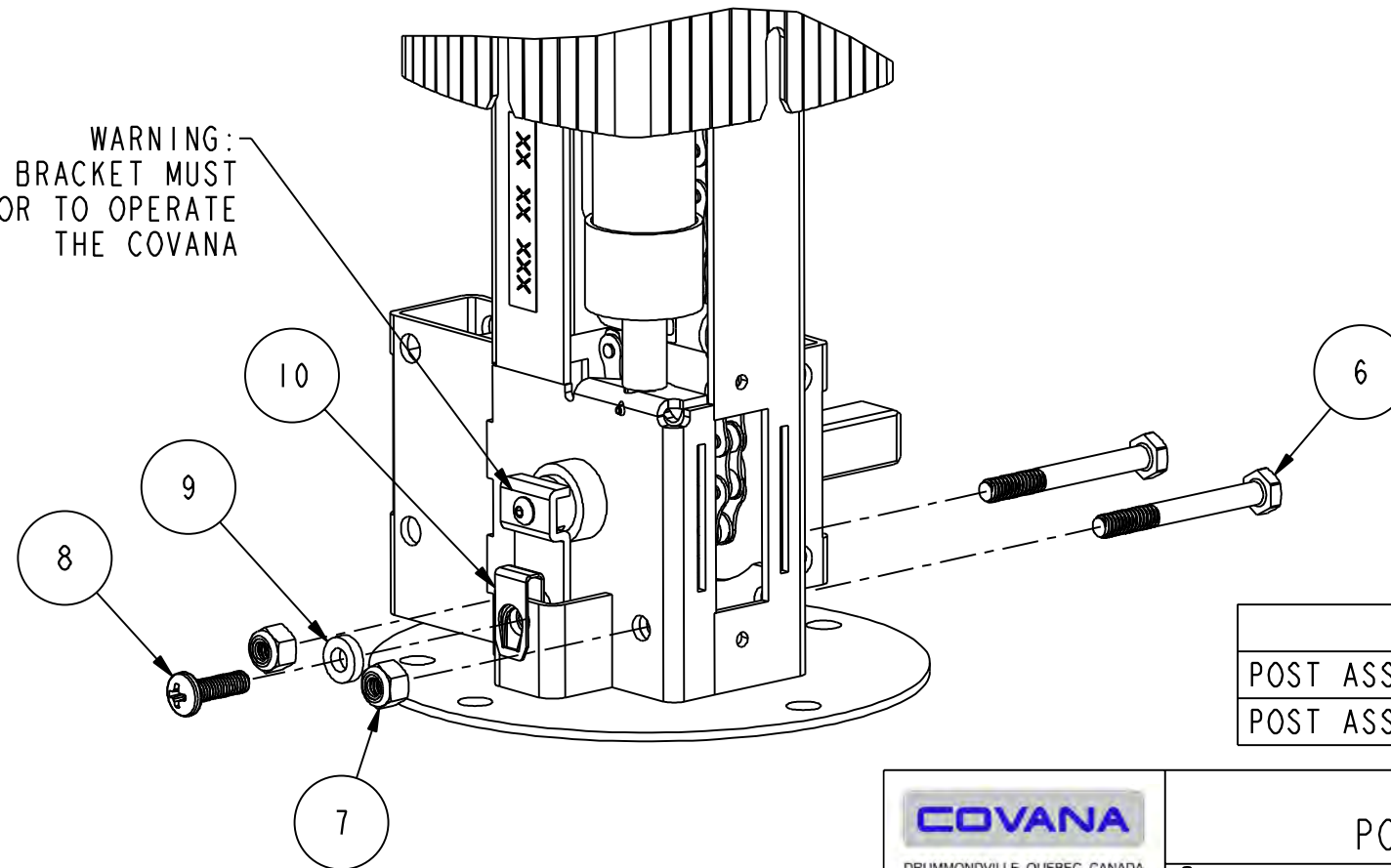
WARNING:  
PACKAGING LOCK BRACKET MUST  
BE REMOVED PRIOR TO OPERATE  
THE COVANA



DESCRIPTION	ARTICLE CODE
POST ASS'Y NO. 1-MOCHA	201331
POST ASS'Y NO. 1-SLATE	201366

 DRUMMONDVILLE, QUEBEC, CANADA TEL: (819) 477-1335, (877) 278-8010 FAX: (819) 477-7212		TITLE	
ARTICLE CODE: SEE TABLE		POST ASS'Y NO. 1-GEN3	
TOLERANCES (IF NOT SPECIFIED)	MATERIAL:	FINISH:	
DRAWN BY: JA.	CHECK BY:	APP. BY: ML.	DATE: 2012/10/01
NO.	DATE	REVISION	BY
SCALE: N.T.S.		DWG. #: OASIS-SP9	REV. PAGE: 1/1

NO.	DATE	REVISION	BY

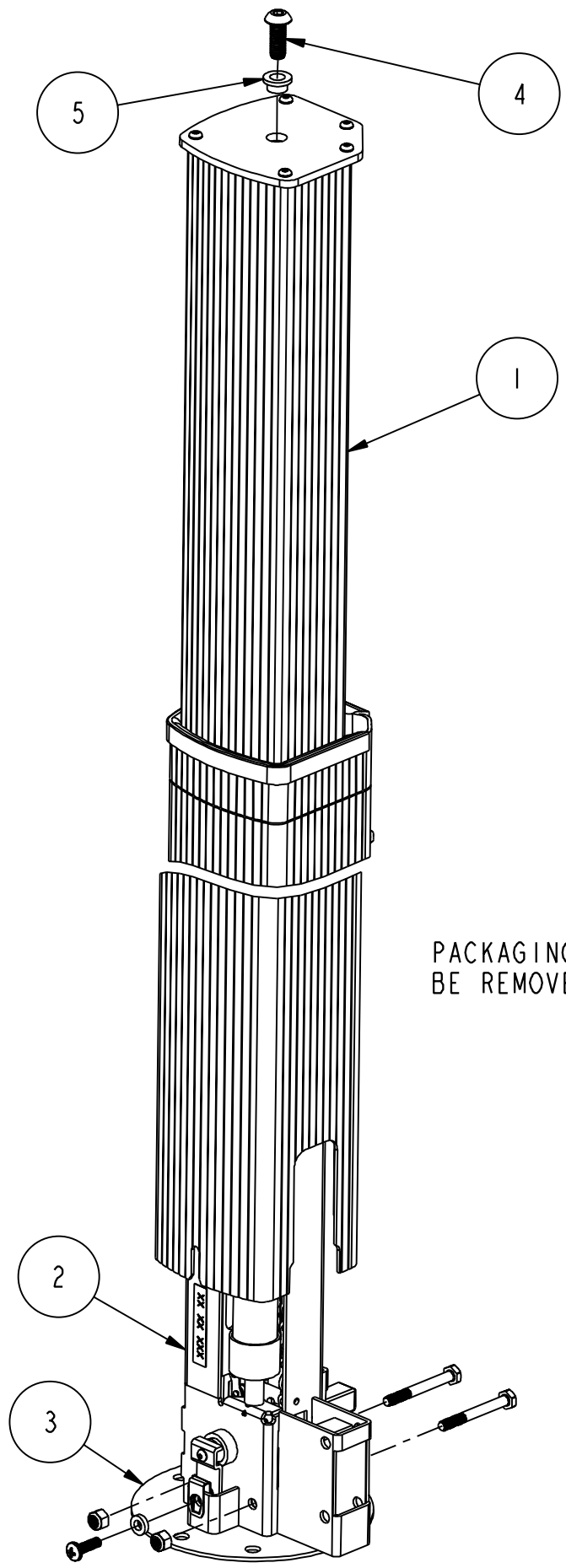

APROX. WEIGHT	
37 Lb	16.7 Kg

No	QTY	DESCRIPTION	ARTICLE CODE
1	1	SLEEVE ASSEMBLY WITH WINTER SEAL-MOCHA	201177
		SLEEVE ASSEMBLY WITH WINTER SEAL-SLATE	201176
2	1	VERTICAL POST-ASS'Y RIGHT(GEN2)	188970
3	1	VERTICAL POST-FOOT-MOCHA	200253
		VERTICAL POST-FOOT-SLATE	200254
4	1	3/8"-24 x 1" BUTTON HEAD SOCKET CAP SCREW-Z/P-MOCHA	202018
		3/8"-24 x 1" BUTTON HEAD SOCKET CAP SCREW-Z/P-SLATE	202017
5	1	BUSHING(9.6-12.5-8.5FL 18.0-2.5)AL-MOCHA	202872
		BUSHING(9.6-12.5-8.5FL 18.0-2.5)AL-SLATE	202873
6	2	1/4"-20 X 2-1/4" HEX CAP SCREW Z/P	188801
7	2	1/4"-20 HEX NYLON LOCK NUT-Z/P	156435
8	1	M6-1.0 x 20mm PHILIPS PAN HEAD MACHINE SCREW-MOCHA	202006
		M6-1.0 x 20mm PHILIPS PAN HEAD MACHINE SCREW-SLATE	202005
9	1	0.257"ID x 0.5"OD x 0.125" THICK NYLON FLAT WASHER	202158
10	1	M6-1.0 (PANEL NUT)	202159

WARNING:  
PACKAGING LOCK BRACKET MUST  
BE REMOVED PRIOR TO OPERATE  
THE COVANA

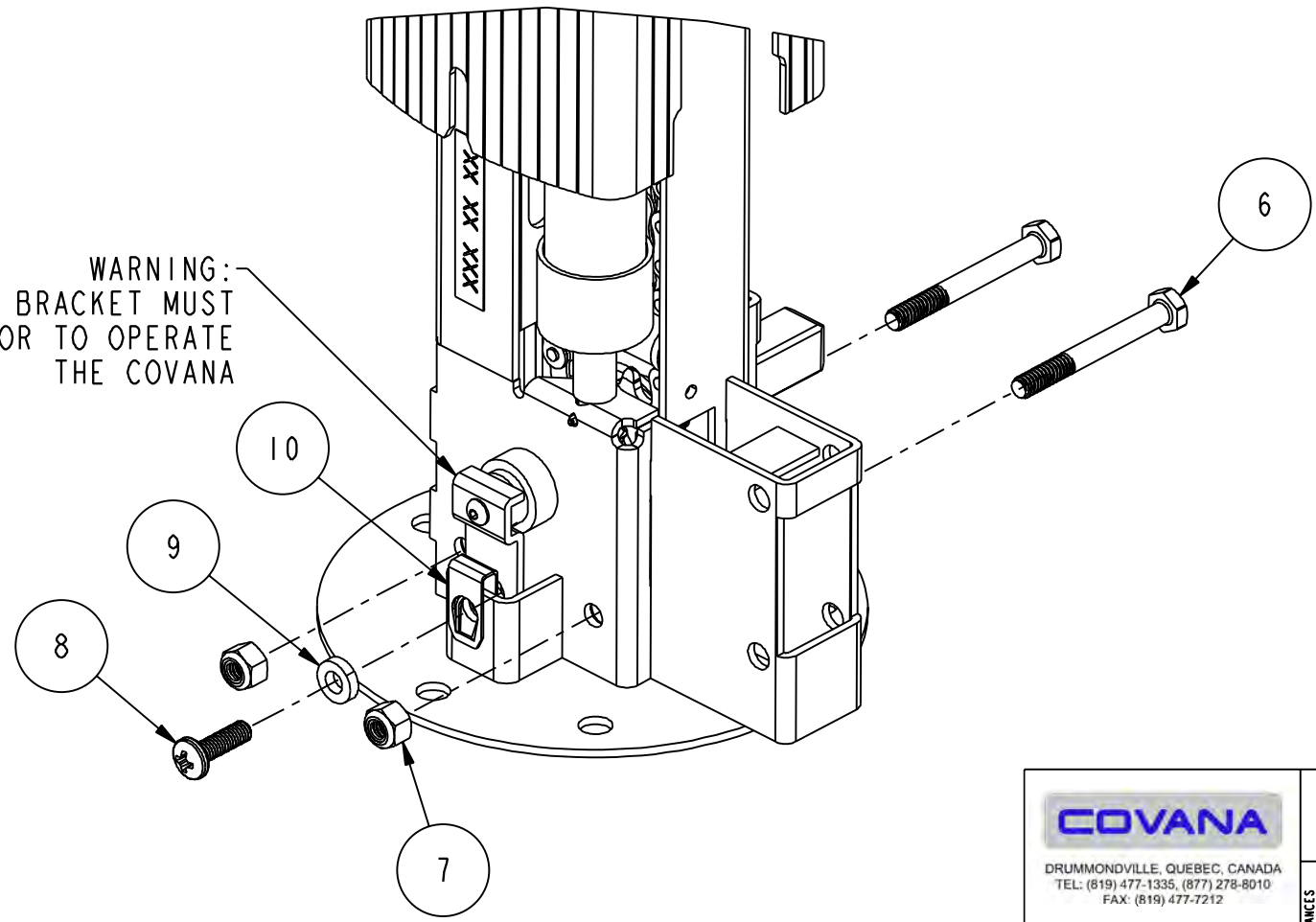

DESCRIPTION	ARTICLE CODE
POST ASS'Y NO.2-MOCHA	201328
POST ASS'Y NO.2-SLATE	201367

 DRUMMONDVILLE, QUEBEC, CANADA TEL: (819) 477-1335, (877) 278-8010 FAX: (819) 477-7212		TITLE <b>POST ASS'Y NO.2-GEN3</b>	
ARTICLE CODE: SEE TABLE	TOLERANCES (IF NOT SPECIFIED)	MATERIAL:	FINISH:
DRAWN BY: <b>JA.</b> CHECK BY: APP. BY: <b>ML.</b>	DATE: 2012/10/01	SCALE: <b>N.T.S.</b>	DWG. # <b>OASIS-SP10</b> REV. <b>1/1</b>

NO.	DATE	REVISION	BY

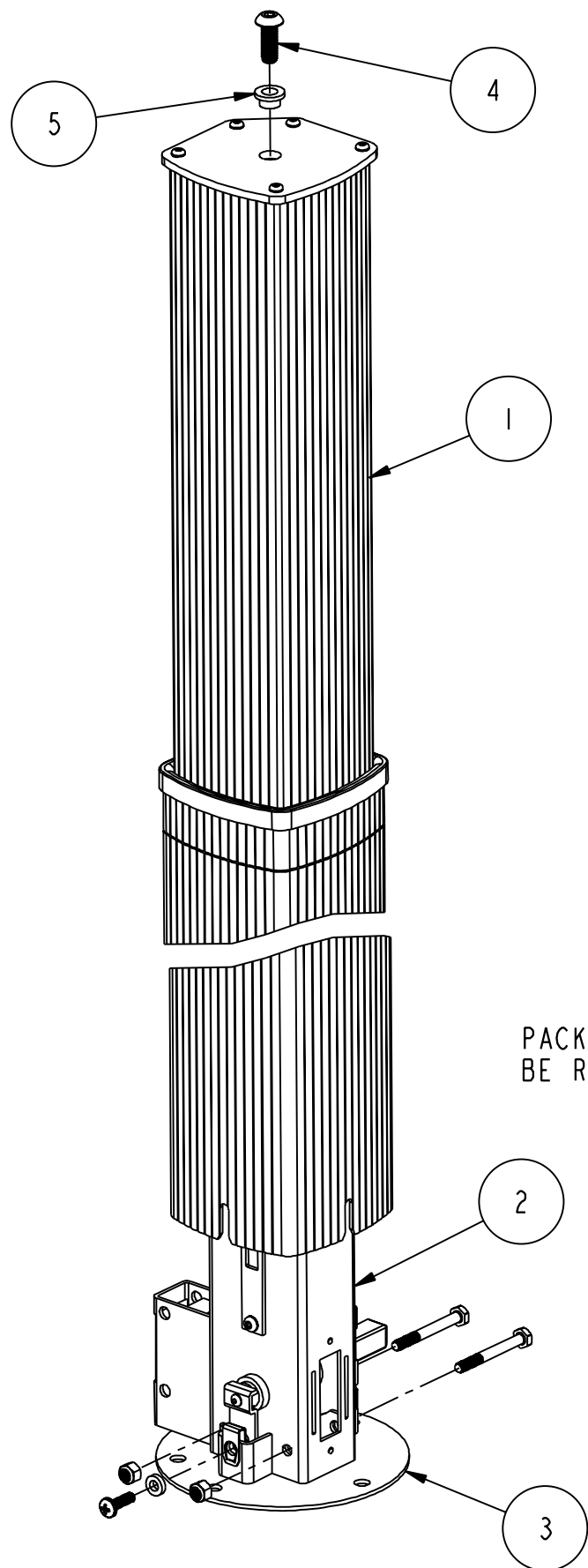

APROX. WEIGHT	
37 Lb	16.7 Kg

No	QTY	DESCRIPTION	ARTICLE CODE
1	1	SLEEVE ASSEMBLY WITH WINTER SEAL-MOCHA	201177
		SLEEVE ASSEMBLY WITH WINTER SEAL-SLATE	201176
2	1	VERTICAL POST-ASS'Y LEFT(GEN2)	188969
3	1	VERTICAL POST-FOOT-MOCHA	200253
		VERTICAL POST-FOOT-SLATE	200254
4	1	3/8"-24 x 1" BUTTON HEAD SOCKET CAP SCREW-Z/P-MOCHA	202018
		3/8"-24 x 1" BUTTON HEAD SOCKET CAP SCREW-Z/P-SLATE	202017
5	1	BUSHING(9.6-12.5-8.5FL 18.0-2.5)AL-MOCHA	202872
		BUSHING(9.6-12.5-8.5FL 18.0-2.5)AL-SLATE	202873
6	2	1/4"-20 X 2-1/4" HEX CAP SCREW Z/P	188801
7	2	1/4"-20 HEX NYLON LOCK NUT-Z/P	156435
8	1	M6-1.0 x 20mm PHILIPS PAN HEAD MACHINE SCREW-MOCHA	202006
		M6-1.0 x 20mm PHILIPS PAN HEAD MACHINE SCREW-SLATE	202005
9	1	0.257"ID x 0.5"OD x 0.125" THICK NYLON FLAT WASHER	202158
10	1	M6-1.0 (PANEL NUT)	202159

WARNING:  
PACKAGING LOCK BRACKET MUST  
BE REMOVED PRIOR TO OPERATE  
THE COVANA

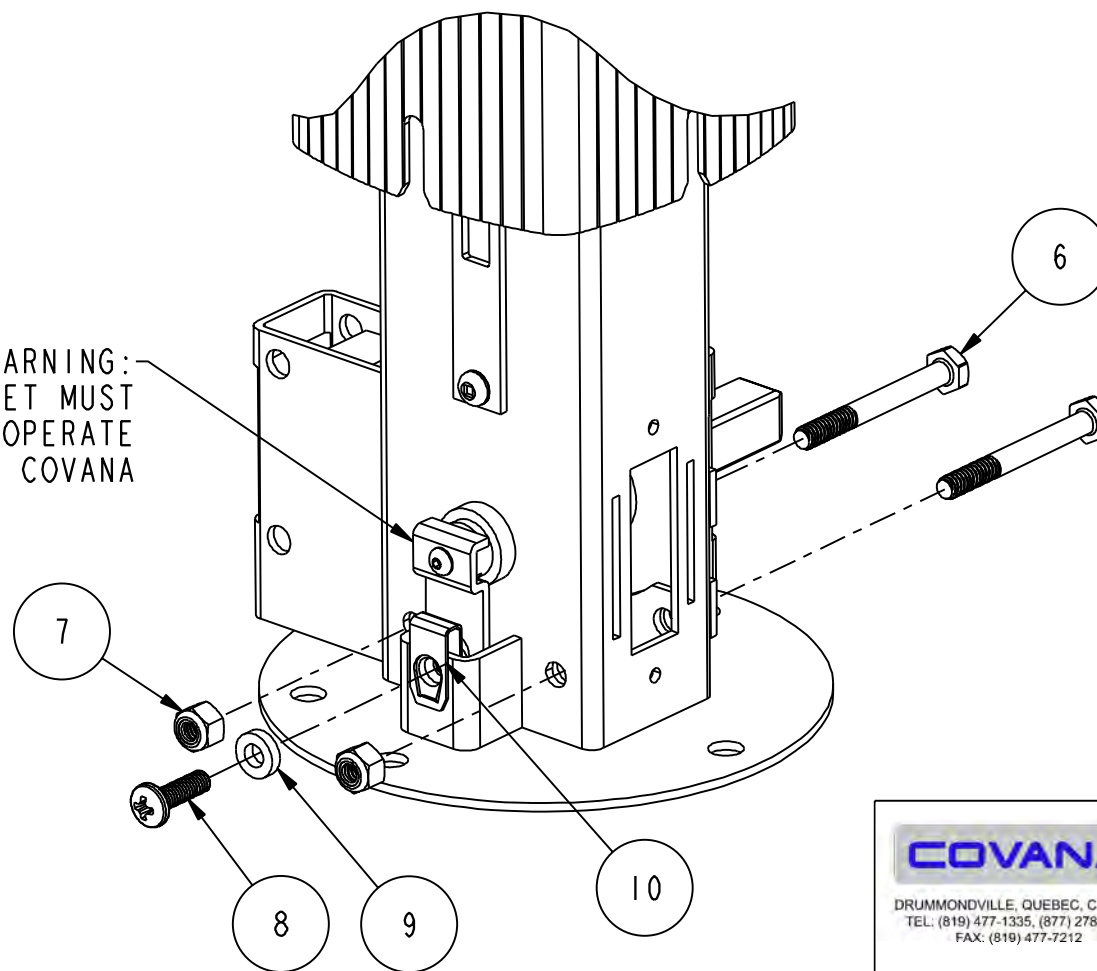

DESCRIPTION	ARTICLE CODE
POST ASS'Y NO.3-MOCHA	201329
POST ASS'Y NO.3-SLATE	201368

 DRUMMONDVILLE, QUEBEC, CANADA TEL: (819) 477-1335, (877) 278-8010 FAX: (819) 477-7212		TITLE	
ARTICLE CODE: SEE TABLE		POST ASS'Y NO.3-GEN3	
TOLERANCES (IF NOT SPECIFIED)	MATERIAL:	FINISH:	
DRAWN BY: JA.	CHECK BY:	APP. BY: ML.	DATE: 2012/10/01
SCALE: N.T.S.	DWG. #: OASIS-SP11	REV.:	PAGE: 1/1

NO.	DATE	REVISION	BY

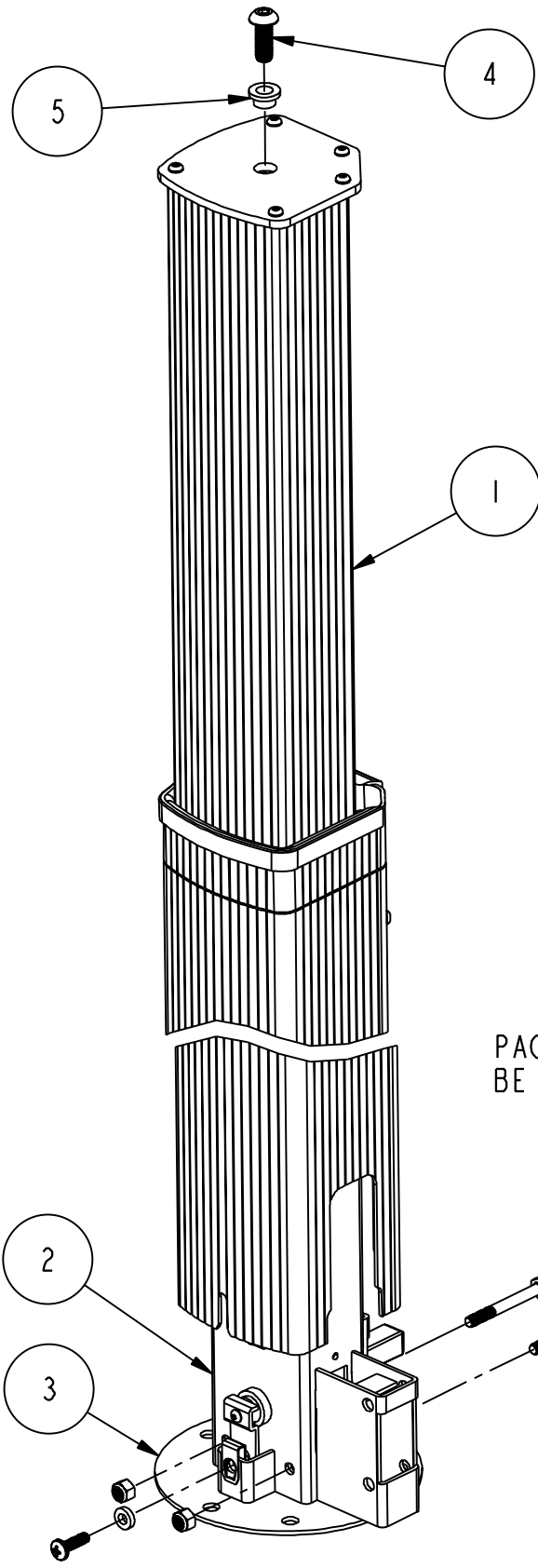

APROX. WEIGHT	
37 Lb	16.7 Kg

No	QTY	DESCRIPTION	ARTICLE CODE
1	1	SLEEVE ASSEMBLY WITH WINTER SEAL-MOCHA	201177
		SLEEVE ASSEMBLY WITH WINTER SEAL-SLATE	201176
2	1	VERTICAL POST-ASS'Y LEFT(GEN2)	188969
3	1	VERTICAL POST-FOOT-MOCHA	200253
		VERTICAL POST-FOOT-SLATE	200254
4	1	3/8"-24 x 1" BUTTON HEAD SOCKET CAP SCREW-Z/P-MOCHA	202018
		3/8"-24 x 1" BUTTON HEAD SOCKET CAP SCREW-Z/P-SLATE	202017
5	1	BUSHING(9.6-12.5-8.5FL 18.0-2.5)AL-MOCHA	202872
		BUSHING(9.6-12.5-8.5FL 18.0-2.5)AL-SLATE	202873
6	2	1/4"-20 X 2-1/4" HEX CAP SCREW Z/P	188801
7	2	1/4"-20 HEX NYLON LOCK NUT-Z/P	156435
8	1	M6-1.0 x 20mm PHILIPS PAN HEAD MACHINE SCREW-MOCHA	202006
		M6-1.0 x 20mm PHILIPS PAN HEAD MACHINE SCREW-SLATE	202005
9	1	0.257" ID x 0.5" OD x 0.125" THICK NYLON FLAT WASHER	202158
10	1	M6-1.0 (PANEL NUT)	202159

WARNING:  
PACKAGING LOCK BRACKET MUST  
BE REMOVED PRIOR TO OPERATE  
THE COVANA

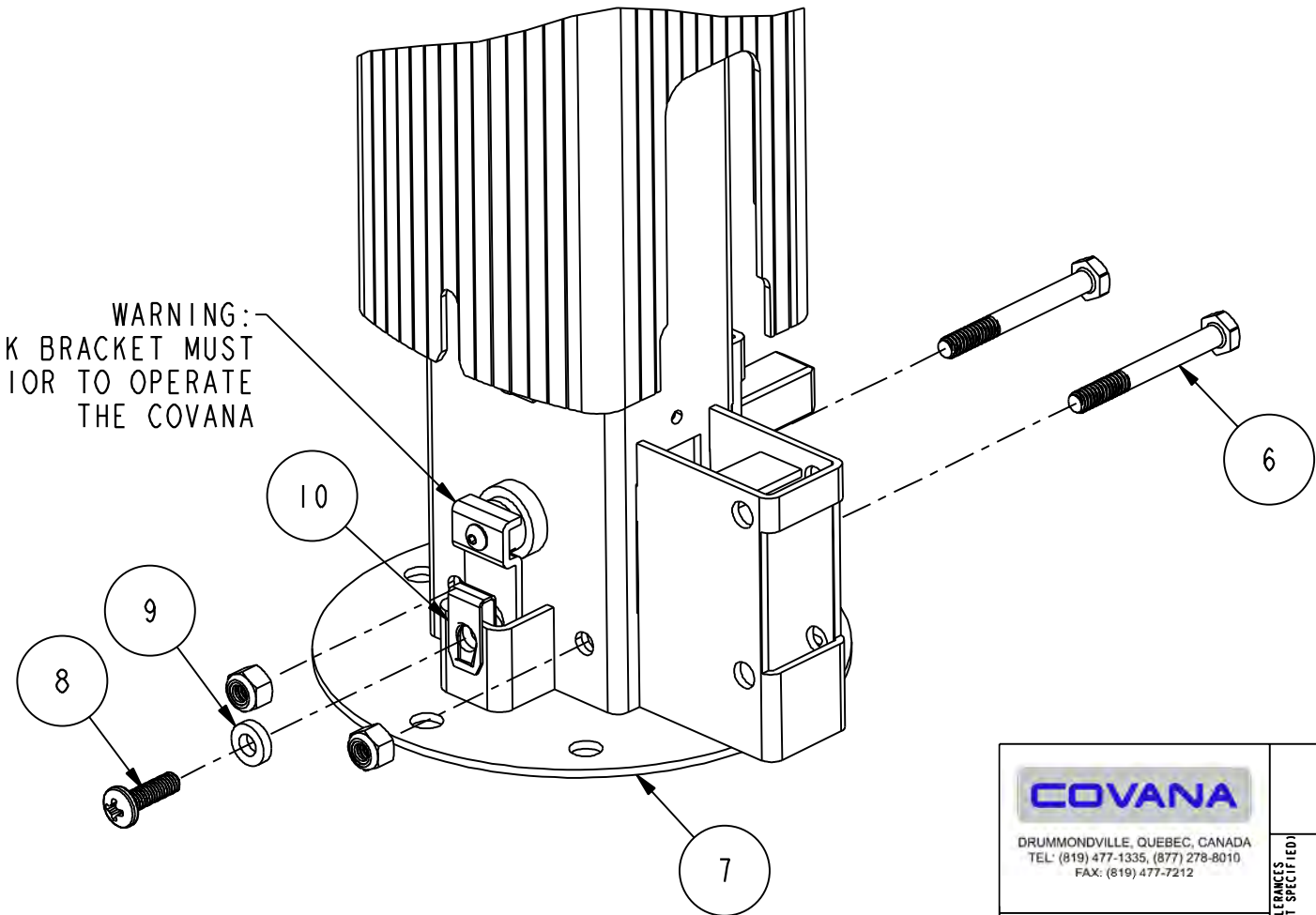

DESCRIPTION	ARTICLE CODE
POST ASS'Y NO. 4-MOCHA	201330
POST ASS'Y NO. 4-SLATE	201369

 DRUMMONDVILLE, QUEBEC, CANADA TEL: (819) 477-1335, (877) 278-8010 FAX: (819) 477-7212		TITLE	
ARTICLE CODE: SEE TABLE		POST ASS'Y NO. 4-GEN3	
TOLERANCES (IF NOT SPECIFIED)	MATERIAL:	FINISH:	
DRAWN BY: JA.	CHECK BY:	APP. BY: ML.	DATE: 2012/10/01
NO.	DATE	REVISION	BY
SCALE: N.T.S.		DWG. #: OASIS-SP12	REV. PAGE: 1/1

NO.	DATE	REVISION	BY

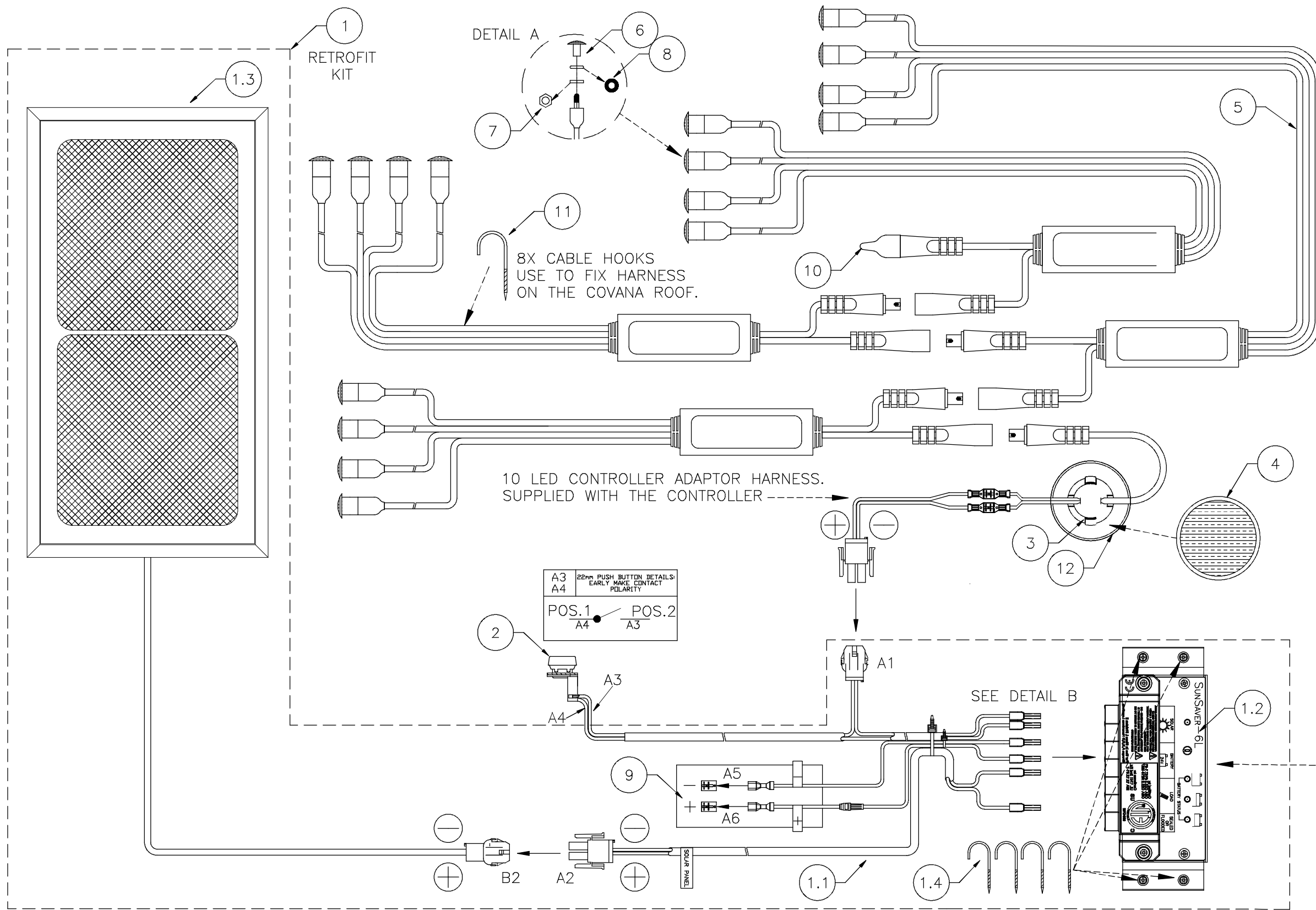

PARTS SPECIFICATION				
ELECTRIC & WIRING SPECIFICATION				
PART	QTY	SUB PART	QTY	ARTICLE CODE
1	1	COVANA LIGHT KIT RETRO FIT		213171
1.1	1	COVANA LIGHT KIT MAIN HARNESS		211829
1.2	1	BATTERY SOLAR CONTROLLER, 12V/6A SEE DETAIL B FOR WIRING.		211697
1.3	1	SOLAR PANEL 12VDC/5W ASSEMBLY WITH MOUNTING TAPE		212882
1.4	4	COVANA LIGHT CABLE HOOK		202019
2	1	22mm NON-ILLUMINATED FLUSH AND N/O MAINTAINED PUSH BUTTON WITH PLASTIC BEZEL ASSEMBLY 240Voc-10A, IP66. SEE DETAIL C		200883
3	1	COVANA LIGHT 10 LED CONTROLLER		200895
4	1	COVANA LIGHT LENS 3", REAR ACCESS CLEAR LENS, GASKET AND NUTS, TO ORDER WITH ITEM 12		200922
5	4	4 LED CABLE ASSEMBLY SEE DETAIL A		200896
6	16	4 LED CABLE LED BULLET LENS SEE DETAIL A		200897
7	16	4 LED CABLE LED NUT SEE DETAIL A		200898
8	16	4 LED CABLE LED O-RING SEE DETAIL A		200899
9	1	12VDC-1.4Ah BATTERY		200882
10	1	CAP 1/2-3/4-VINYL		203028
11	8	COVANA LIGHT CABLE HOOK		202019
12	1	COVANA LIGHT REFLECTOR HOUSING		202817

**COVANA**  
 DRUMMONDVILLE, QUEBEC, CANADA  
 TEL: (819) 477-1335, (877) 278-8010  
 FAX: (819) 477-7212

TITLE  
 COVANA LIGHT ASSEMBLY OPTION - GEN 3

MATERIAL  
 ---

FINISH  
 ---

ARTICLE CODE: **201287**  
 DRAWN BY: **E.B.** APP. BY: **F.P.**

SCALE: **N.T.S.** DWG #: **OASIS-SP13** REV. **4** PAGE **1/1**

NO.	DATE	REVISION	BY

DATE: 2010/02/05